

20

ADMIRAL SE®

06



HOLIDAY RAMBLER®

This is Living®





STEP UP WITH A COMPANY YOU CAN COUNT ON.

Now's the time. You're ready. Your family's ready. And the full-sized adventures of a full-sized motorhome are waiting. For peace of mind, nothing beats the quality and reliability of Holiday Rambler's Admiral SE. Yes, it's a big investment. But with more standard features, great warranties and the very best owner support in the industry, it's also an exceptional value. We know how much you love the outdoors. Now, you can go farther, live larger and experience it all — plus, turn a few heads along the way. This is the right coach at the right time. The 2006 Admiral SE.



THIS IS WHERE WE INVITE YOU TO KEEP SCORE.

Climb aboard other motorhomes, and the first thing you want to do is duck. Not so in the Admiral SE, thanks to its full seven feet of ceiling height. We also encourage you to take a closer look at the quality and workmanship inside the coach. You'll find many residential details and finishing touches, including the beautiful cabinetry with raised panel overhead cabinet doors, crown molding and wood slide-out fascia. Plush fabric furnishings come standard, and you're welcome to customize your interior with a wide range of furniture options, including a stylish OptimaLeather™ Euro-recliner with ottoman.



A) You'll relax in style in the Admiral SE's bedroom, with a queen bed and beautiful color-coordinated bedspread and decorative pillows. You'll find plenty of storage space to help keep things tidy, and for your entertainment, there's an optional 20" TV tucked in a swing-away cabinet (a stationary cabinet on the 36DBD). Two bedroom floorplans of note include the 37PCT with a desk and barrel chair and the 36DBD with a private bath in the rear of the coach.

GATHER AROUND AND SHARE YOUR EXPERIENCES.

The kitchen and dining area are the hub of your daily life, and in the Admiral SE, you'll have everything you need to create gatherings to remember. Every inch is put to good use, with pantry storage, overhead cabinets with an adjustable shelf, a silverware drawer organizer and a trash can in the base cabinets. At the sink you'll find a single-lever brushed nickel faucet and a handy separate faucet for filtered water. The top-notch appliances include a large double-door refrigerator (a four-door model with ice maker is optional), a high-output three-burner cooktop and a versatile microwave/convection oven.



- A) The vanity and medicine cabinet offer plenty of storage space to keep your essentials in place while traveling. An easy-to-clean one-piece fiberglass shower comes standard (a bathtub is optional) and features a stylish obscure glass enclosure. A thoughtful touch is a light on the wall inside the shower.
- B) The beautiful arched-back wood booth dinette offers the convenience of a side-slide adjustable table top and a large, 30" storage drawer. If you prefer, you may choose the option of a freestanding dinette with two stylish chairs and two folding chairs.



THIS IS OUR COMMITMENT TO SAFETY.

Virtually every feature in the roomy cockpit is designed to enhance your safety and comfort on the road. It all begins with our steel cage cockpit construction, giving you maximum protection. For eyes and ears behind the coach, you have the option of either a rear vision system with audio or the new three-camera system with adjustable center camera. Another convenient option is a driver's side door with power window.



1-PIECE WINDSHIELD

You'll have the largest, and safest, unobstructed view in the industry, thanks to our exclusive Panaview™ 1-piece windshield. Slender side pillars increase your peripheral vision and the wipers are conveniently mounted below your line of sight. The exterior mirrors are also mounted on the front cap — so you don't have to turn your head away from the road. Inside the cockpit, optional power sunvisors and pull-down sunshades eliminate dangerous glare.

- A) The automotive dash features a burlwood instrumentation panel with easy-to-read gauges. Power steering, intermittent wipers, cruise control and a CD player all come standard, and the prep for a CB radio is optional.
- B) Our side-hinged baggage doors are the absolute simplest to use, making it easier to reach inside the storage compartments and giving you a better view.



A



HOW DO WE FIGHT DRIVER FATIGUE? WITH MORE COMFORTABLE SEATS.

Longer drives are a breeze in the comfort of the Admiral SE's cockpit seats. Fabric seats come standard, or you have the option of soft touch vinyl. For the optimum driving position, the pilot's seat has six-way power controls, which are optional for the co-pilot. A wood center console houses cup holders and either a tip door or front drawer, depending on the chassis. The co-pilot has a handy dash workstation, the perfect place for a laptop computer.

WE'VE GOT YOUR BACK.

- Live customer support 24/7/365
- 350 Nationwide Service Centers
- Free first-year enrollment in our Owner Advantage Roadside Assistance Program
- Call 1-800-634-0855 or 1-800-650-7337 to arrange a tour of one of our state-of-the-art production facilities in Indiana or Oregon.

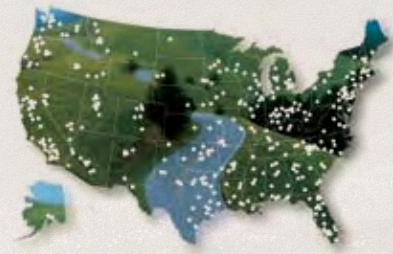

WHERE ALL THE DETAILS COME TOGETHER.

Holiday Rambler has long set the standard with warm, inviting interiors that feature a perfect harmony of fabrics, accents and carpeting. We've also led the way with stunning woodwork and superb craftsmanship, including raised panel cabinet doors, self-supporting top-hinged overhead doors, wood drawer boxes and heavy-duty ball bearing guides. Select the combination that suits you best to customize your Admiral SE and make it distinctively your own.

- A. BEDSPREAD
- B. SOFA
- C. CARPET
- D. ACCENT

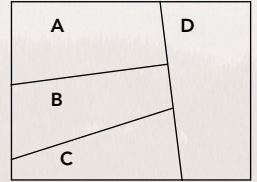

EXTERIOR COLORS/WOODS/FABRICS



FULL-BODY PAINT

VINYL EXTERIOR GRAPHICS

30PDD



BRONZEVILLE



FULL-BODY PAINT

VINYL EXTERIOR GRAPHICS

30PDD



EBONY VINE II

BETTER STAIN PROTECTION



Manufactured in, not added on. For added protection against stains, soil repellent is applied to virtually all upholstery fabric during the finishing process for superior coverage.*

*Brand and application of upholstery fabric protection may vary depending on date recreational vehicle was manufactured.

ADMIRAL SE HARDWARE

Our elegant cabinet hardware design features a satin brass finish.



NEW VINTAGE OAK



NEWPORT CHERRY



CHAMPAGNE SELECT



JADESTONE



FULL-BODY PAINT

VINYL EXTERIOR GRAPHICS

30PDD



MOROCCAN SUNSET



FULL-BODY PAINT

VINYL EXTERIOR GRAPHICS

30PDD



SAVILLE ROW II



FULL-BODY PAINT

VINYL EXTERIOR GRAPHICS

30PDD

EXTERIOR COLORS/WOODS/FABRICS

See page 17 for more info on the 30PDD.

SMARTSTRUCTURE II: STRONGER AND BETTER

The SmartStructure II truss system provides unbeatable chassis strength by maximizing the inherent strengths of its strain-hardened steel. For seamless performance, SmartStructure II is fully integrated with your choice of Ford or Workhorse chassis.

Strain-hardened steel combines with an aerodynamic metal removal principle to allow stress flow in the truss system to evenly distribute both static and dynamic loading across the coach platform.

Integrity is stamped into the truss system, instead of relying on the welds of the tubular structure. This equates to 40% fewer welds, and, along with strategically located metal removal, reduces the overall chassis weight and provides for greater carrying capacity.

4,000 lb. hitch receiver with 4-pin or 7-pin dual connector.

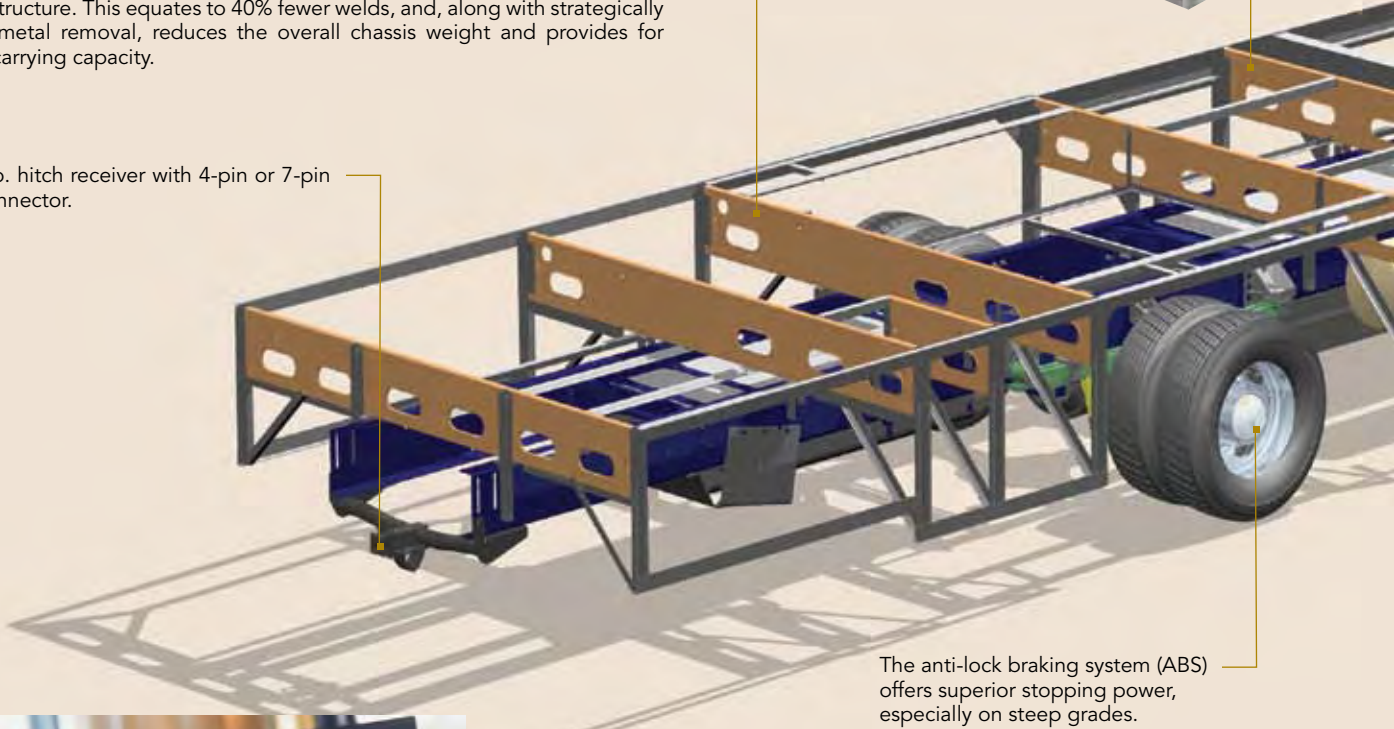
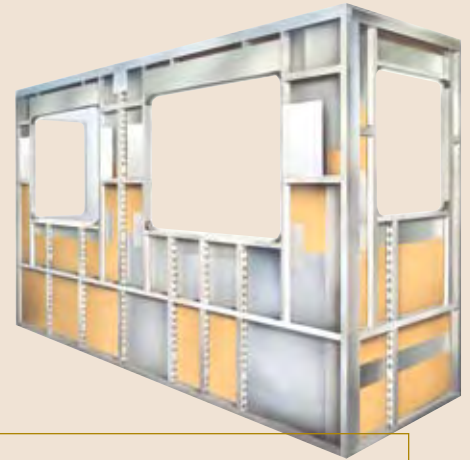

The anti-lock braking system (ABS) offers superior stopping power, especially on steep grades.



AT HOLIDAYRAMBLER.COM, WE'RE ALWAYS OPEN.

Visit our website anytime day or night to check out the latest product news and updates. You can also take a factory tour, find a dealer near you, get information on club events and much more. It's also an easy way to contact us via e-mail.

www.holidayrambler.com

5-LAYER SIDEWALL CONSTRUCTION: (left to right)

- Smooth gel coat fiberglass is standard on 33'-37' models; smooth .060 aluminum is standard on 30PDD
- Interlocking C-Channel filled with 1-1/2" fiberglass insulation bonded in place so it doesn't sag or leave spaces uninsulated
- Vapor barrier
- Bead foam adds comfort, saves energy and provides a thermal insulative barrier
- Interior paneling

SLIDE-OUT CONSTRUCTION:

When you get a Holiday Rambler, you can be sure the slide-out boxes are some of the strongest and most reliable you'll find anywhere. They feature our exclusive multi-layer construction to give you maximum insulation and to reduce the chance of warping, twisting or shifting.

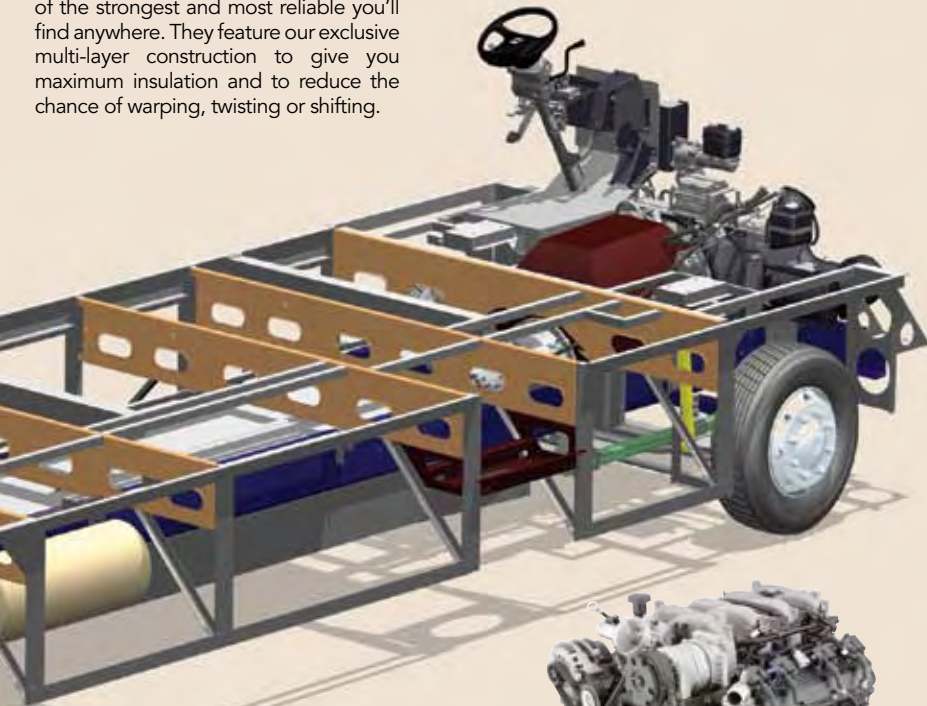

9-LAYER ROOF CONSTRUCTION: (top to bottom)

- One-piece peaked fiberglass roof
- Luau backing
- Thick, tapered bead foam insulation
- Aluminum double I-beam superstructure filled with fiberglass insulation
- Vapor barrier
- Structure foam: thermal insulative barrier
- 1/2" bead foam insulation
- Foam padding for extra insulation
- Padded vinyl ceiling

VORTEC:

Shown here is the Workhorse chassis' Vortec™ 8100, 8.1L V8 engine. It features 340 HP and 455 lbs./ft. torque. The Ford chassis comes standard with a 6.8L 3-valve V-10 engine with 362 HP and 457 lbs./ft torque.

ALUMAFRAME® CONSTRUCTION SINCE 1966:

The Admiral SE features Holiday Rambler's exclusive Alumaframe® Superstructure. Our revolutionary system of aluminum C-Channel crossmembers runs the entire length of the unit, with double-welded intersections for added strength. This rigid design is both lighter and sturdier than wood or tubular aluminum frames — and much more reliable than butt-welded or screwed joint designs. From dirt roads to potholes, you can count on Alumaframe® to handle the relentless stresses of the road and provide superior structural integrity for many years to come.

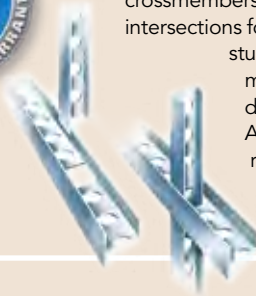

Wood Aluminum (Butt-Welded) Alumaframe® (C-Channel)

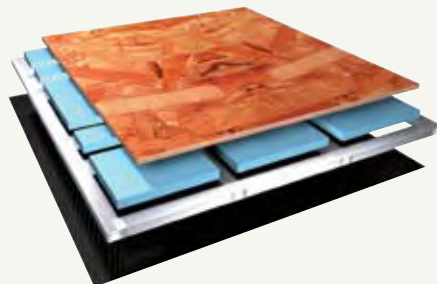

4-LAYER FLOOR CONSTRUCTION: (top to bottom)

- Structurwood™
- Blue foam insulation
- 1-1/2" aluminum tube
- Three-ply poly underbelly

BODY CONSTRUCTION: FEATURES		OPTIONS
<ul style="list-style-type: none"> Alumaframe® Superstructure Steel Cage Cockpit Construction Peaked 1-Piece Fiberglass Roof with Fiberglass Insulation Smooth Gel Coat Fiberglass Exterior Walls Front and Rear Molded Fiberglass Caps Panaview™ 1-Piece Front Windshield Interior Height, 84" Aluminum Framed Floor on Steel Trusses Laminated Structurwood™ Flooring Interior Paneling with 3/4" Insulation Foam Insulated Floor Framing with 3-Ply Underbelly One-Piece Engine Cover Power Heated Remote Exterior Mirrors Low-Profile Sealed LED Marker Lights New Style Taillights Integrated Metal Fuel Door with Lock 	<ul style="list-style-type: none"> 30" Deep Bedroom Slide-Out Houses (N/A: 34SBD) Pass-Through Storage Bays under Slide-Outs with Roto Cast Boxes Side-Hinged Baggage Doors; All Door Locations with Redesigned Extrusion and Latch Locations One-Piece Polyethylene Storage Compartment Add Exterior Storage above LP Tank Painted Mask and Skirt with Vinyl Exterior Graphics Rear Ladder Interior Rubber Entry Steps with Built-In Stepwell Storage Bucket Exterior Triple Entry Steps (N/A: 33PBD) Exterior Double Entry Steps (33PBD) Undercoating 	<ul style="list-style-type: none"> Deluxe Full-Body Paint with Vinyl Graphics; Any Awning Selected with Full-Body Paint will have Metal Cover 3M Film Front Mask Standard Run Savings Package: Soft Touch Vinyl Pilot & Co-Pilot Seats, Rear Vision System w/Audio & Adjustable Camera, Power Sunvisors, Pilot & Co-Pilot Side Window Pull-Down Sunshades, Large Double-Door Refrigerator w/Ice Maker 10 Cu. Ft., 20" Color TV w/Remote Control in Bedroom, DVD Player, Hardwood Raised Panel Doors on Refrigerator, Energy Management System w/50 Amp Service, 140 Watt Inverter, Storage Compartment Tank Monitor Gauge, Fantastic 12V Attic Fan w/Rain Sensor w/Electronic Wall Thermostat in Bath, 12V Heater in Wet Bay, Heat Pad on Fresh Tank, Radius Flush-Mount Dual Pane Safety Glass Dark Tinted Slider Windows, Texture Vinyl Patio Awning Upgrade Standard Run Savings Package: Includes all Standard Run Savings Package Items Plus 3-Camera Rear Vision System w/Audio & Adjustable Camera, Large Four-Door Refrigerator w/Ice-Maker
FORD 20,500 LB. CHASSIS/ENGINE/SUSPENSION (33PBD): FEATURES		
<ul style="list-style-type: none"> 6.8L 3-Valve V-10 Gasoline Engine with Electronic Fuel Injection Engine Displacement: 6.8L/415 Cu. In. Power: 362 HP Torque: 457 lbs./ft. TorqShift 5-Speed Automatic Overdrive Transmission with Tow/Haul Mode New Transmission Oil Temperature Gauge 	<ul style="list-style-type: none"> Fuel Tank Capacity 75 Gallon 130 Amp Alternator Rear Axle Ratio: 5.38:1 Radial Tires: 245/70R/19.5F Wheel/Rims Chrome Wheel Covers Leaf Spring Suspension Front and Rear Disc, 4-Wheel Anti-Lock Brakes 	<ul style="list-style-type: none"> Heavy-Duty Front Track Bar with Bilstein® Shock Absorbers Fully Automatic Hydraulic Leveling System Pre-Wire for Supplemental Braking System Hitch Receiver with Dual Connector 4-Pin or 7-Pin, 5,000 Lb. Hitch SmartStructure II
WORKHORSE 20,700 LB. CHASSIS/ENGINE/SUSPENSION (33PBD): FEATURES		
<ul style="list-style-type: none"> 8.1L V-8 Gasoline Engine with Electronic Fuel Injection Engine Displacement: 8.1L/496 Cu. In. Power: 340 HP Torque: 455 lbs./ft. 6-Speed Automatic Transmission with Overdrive 	<ul style="list-style-type: none"> Fuel Tank Capacity 75 Gallon 145 Amp Alternator Rear Axle Ratio: 5.13:1 Radial Tires: 245/70R x 19.5F Stainless Steel Wheel Liners Leaf Spring Suspension ABS Brake System 	<ul style="list-style-type: none"> Fully Automatic Hydraulic Leveling System Pre-Wire for Supplemental Braking System Hitch Receiver with Dual Connector 4-Pin or 7-Pin, 5,000 Lb. Hitch SmartStructure II
FORD 22,000 LB. CHASSIS/ENGINE/SUSPENSION (N/A: 33PBD): FEATURES		
<ul style="list-style-type: none"> 6.8L 3-Valve V-10 Gasoline Engine with Electronic Fuel Injection Engine Displacement: 6.8L/415 Cu. In. Power: 362 HP Torque: 457 lbs./ft. TorqShift 5-Speed Automatic Overdrive Transmission with Tow/Haul Mode New Transmission Oil Temperature Gauge 	<ul style="list-style-type: none"> Fuel Tank Capacity 75 Gallon 130 Amp Alternator Rear Axle Ratio: 5.38:1 Radial Tires: 235/80R/22.5G Wheel Polished Aluminum Leaf Spring Suspension Front and Rear Disc, 4-Wheel Anti-Lock Brakes 	<ul style="list-style-type: none"> Heavy-Duty Front Track Bar with Bilstein® Shock Absorbers Fully Automatic Hydraulic Leveling System Pre-Wire for Supplemental Braking System Hitch Receiver with Dual Connector 4-Pin or 7-Pin, 4,000 Lb. Hitch SmartStructure II
WORKHORSE 22,000 LB. CHASSIS/ENGINE/SUSPENSION (N/A: 33PBD): FEATURES		
<ul style="list-style-type: none"> 8.1L V-8 Gasoline Engine with Electronic Fuel Injection Engine Displacement: 8.1L/496 Cu. In. Power: 340 HP Torque: 455 lbs./ft. 6-Speed Automatic Transmission with Overdrive 	<ul style="list-style-type: none"> Fuel Tank Capacity 75 Gallon 145 Amp Alternator Rear Axle Ratio: 5.86:1 Radial Tires: 235/80R/22.5G Stainless Steel Wheel Liners Leaf Spring Suspension ABS Brake System 	<ul style="list-style-type: none"> Fully Automatic Hydraulic Leveling System Pre-Wire for Supplemental Braking System Hitch Receiver with Dual Connector 4-Pin or 7-Pin, 4,000 Lb. Hitch SmartStructure II

COCKPIT: FEATURES	OPTIONS
<ul style="list-style-type: none"> • Fiberglass Automotive Dash with Burlwood Instrumentation Panel and Two-Tone Dash Vinyl • CD Player/Radio with Six Speakers • Multi-Positioned Sunvisors • Rear Vision System Prep • Intermittent Windshield Wipers • Tilt Steering Wheel • Cruise Control • Power Steering • Electric Automotive Horn • Wood Center Console on Engine Cover, Recess Tray with Rubber Mat and Plastic Two-Tier Cup Holders: Front Tip-Door Ford / Front Drawer Workhorse Chassis • New Style Fabric Pilot and Co-Pilot Recliner Seats • Six-Way Power Pilot Seat • Carpeted Driver and Passenger Floor Mats • Dash Workstation • Wood Framed Cabinet Doors with Smoked Glass over Front Entertainment Center Systems • Secure Front Cab over TVs with Steel Framing 	<ul style="list-style-type: none"> • Six-Way Power Co-Pilot Seat • Soft Touch Vinyl Pilot and Co-Pilot Seats • Rear Vision System with Audio and Adjustable Camera • 3-Camera Rear Vision System with Audio and Adjustable Center Camera • Power Sunvisors • Pilot and Co-Pilot Side Window Pull-Down Sunshades • CB Radio Prep • Driver's Side Door with Power Window
APPLIANCES AND ACCESSORIES: FEATURES	OPTIONS
<ul style="list-style-type: none"> • Large Double-Door Refrigerator • High-Output 3-Burner Cooktop without Oven • Bi-Fold Range Cover • Spacesaver Convection Microwave with Touch Control • 24" Flatscreen Stereo Color TV with Remote Control in Cockpit Overhead • TV Antenna • DVD Prep and Video Control Box with Booster • Exterior Hook-Ups for DSS Dish and Cable • Interior Cable TV Hook-Up and Telephone Jacks • Digital Satellite System Prep • Exterior Gas Line Hook-Up Prep for LP Accessories 	<ul style="list-style-type: none"> • Large Double-Door Refrigerator with Ice Maker • Large Double-Door Refrigerator with Ice Maker 10 Cu. Ft. • Large Four-Door Refrigerator with Ice Maker (N/A with Pantry) • High-Output Three-Burner Range with Oven • Washer/Dryer Prep, Requires 50 Amp Service Option (N/A: 34SBD, 37PCT) • Combination Washer/Dryer, Requires Washer/Dryer Prep Option (N/A: 34SBD, 37PCT) • 20" Color TV with Remote Control in Bedroom • DVD Player • Exterior Entertainment Center, CD Player Radio with Two Speakers
INTERIOR: FEATURES	OPTIONS
<ul style="list-style-type: none"> • New Vintage Oak Cabinetry • Raised Panel Cabinet Doors on Overhead Cabinets, Flat Panel Doors on Base Cabinets and Wardrobes • Cabinet End Panels • Black ABS Refrigerator Insert • Wallpaper Border Kitchen and Bath • Self-Supporting Top-Hinged Overhead Storage Doors and Positive Catches on All Other Doors • Heavy-Duty Ball Bearing Drawer Guides • Wood Cabinet Drawer Boxes • Wood Interior Grab Handle on Cabinet at Entry Door • Brass Finished Entry Rail for Stepwell (N/A with Computer Desk Selection 37PBD) • Satin Brass Cabinetry Hardware and Bath Accessories • Laminated Kitchen Countertop with Decorative Backsplash, Stainless Steel Sink, Brushed Nickel Faucet and Two Sink Covers • Integrated Cup Holder next to Sofa • Toe Kicks Kitchen and Bath Base Cabinets • Laminate Bathroom Countertop with Decorative Backsplash and Laminate Perm-Edge • All Other Countertops are Laminate with Wood-Edge • Kitchen Overhead Cabinets with Adjustable Shelf • Kitchen Pantry next to Refrigerator with Adjustable Shelves in Upper Cabinet and Three Drawers Below (N/A with Four-Door Refrigerator Option) • Silverware Drawer, Organizer Kitchen Base Cabinets (N/A with Range Option) • Trash Can in Kitchen Base Cabinet • Laminate Tile Flooring Kitchen and Bath, Kitchen Flooring to Include Entry Door • Rear Bath Flooring to Match Flooring in Kitchen and Front Bath (36DBD) • Upgrade Nylon Carpeting with Pad in Living Area and Bedroom • Soft Touch Padded Vinyl Ceiling • Wood Slide-Out Fascia with Vinyl Inserts • Elongated Beveled Octagon Living Area or Bedroom Mirror • Picture Living or Bedroom Area (34SBD, 37PBD) • Hutch with Glass Doors/Back Lighted Glass (37PCT) • Bath Door with Accent Trim on Hallway Side • Wood Trim for Bath Door Opening Hallway Side • Wood Louvers on Washer and Dryer Doors (N/A: 34SBD, 37PCT) • French Style Door into Bedroom (37PCT) • Magazine Rack Bathroom (36DBD, 37PCT) • Wood Grain Crown Molding in Bedroom and Living Area on All Open Walls • Bathroom Lavatory Base Mirror with Wood Frame • Accent Mirror Trim on Rear Wall (34SBD) • Side Wardrobe Closet with Deluxe Mirror Door Frames Brass Finish (33PBD, 37PBD) • Bedroom Swing-Away TV Cabinets (Stationary 36DBD) • Bedspread with Two Decorative Pillows • New Fabric Headboard • Pleated Day/Night Blackout Shades in Living Area and Bedroom, Mini Blinds in Kitchen and Bathroom, Where Applicable • Soil Repellant on Fabric 	<ul style="list-style-type: none"> • Decors: Moroccan Sunset, Saville Row II, Bronzeville, Jadestone, Ebony Vine II • Wood Choice: Newport Cherry, Champagne Select • Hardwood Raised Panel Doors on Refrigerator

FURNITURE: FEATURES	OPTIONS	
<ul style="list-style-type: none"> • Queen Bed with Nightstands • Arched Back Wood Booth Dinette, with Side Sliding Table Top and 30" Drawer • Forward-Facing Seat Belts in Booth Dinette inside Living Area Slide-Out • New Style Fabric Jackknife Sofa, Two Pillows on All Sofas • New Style Fabric Swivel Glider Barrel Chair • Fabric Swivel Glider Barrel Chair and Desk Chair Bedroom (37PCT) 	<ul style="list-style-type: none"> • New Style Fabric Hide-A-Bed Sofa with Two Pillows • New Style Fabric Hide-A-Bed Sofa with Air Mattress and Two Pillows • Curbside: New Style Soft Touch Vinyl J-Lounge IPO Swivel Glider Barrel Chair and Computer Desk (37PBD) • New Style Soft Touch Vinyl Swivel Recliner Chair IPO Fabric Swivel Glider Barrel Chair • OptimaLeather™ Euro-Recliner Chair with Ottoman IPO Barrel Chair 	<ul style="list-style-type: none"> • Fabric Swivel Glider Barrel Chair with Center Lift-Up Table IPO Desk and Desk Chair Bedroom (37PCT) • Curbside: Two New Style Soft Touch Vinyl Recliners IPO Swivel Glider Barrel Chair and Computer Desk (37PBD) • Bedroom Desk (34SBD, 36DBD) • Freestanding Dinette with Two Freestanding Chairs and Two Folding Chairs
ELECTRICAL SYSTEMS AND LIGHTS: FEATURES	OPTIONS	
<ul style="list-style-type: none"> • 30 Amp 120V Distribution Panel and Power Cord • 60 Amp Electronic 12V Power Converter • Onan® 5.5 kW Gas Generator • Two 6V House Batteries • Battery Disconnect Switches • 12V and 110V Outlet in Cockpit Area • Porch Light and Exterior Step Light on Same Switch • Exterior Power Entry Step with Light • Interior Stepwell Entry Step Lights • Water Pump Switch in Service Bay Area and Convenience Center • Lights in Outside Storage Compartments • 120V Receptacles in Outside Storage Compartment • Underhood Utility Light • Receptacle and Phone Jack in Dinette Area 	<ul style="list-style-type: none"> • Directional Map Lights Pilot and Co-Pilot Seats • Redesigned Convenience Center in Hallway • Fluorescent Light(s) with Night Light Function under Kitchen Overhead • Fluorescent Ceiling Lights Throughout • Fluorescent Ceiling Lights inside Living Area Slide-Out House • Decorative Wood Framed Galley Ceiling Fluorescent Light • Decorative Satin Brass Lighting Living Room Wall Light, Dinette Overhead, Bedroom Cosmetic Vanity Light • Satin Brass Decorative Bathroom Cabinet Light with Cover • Halogen Lights under Living Room and Dining Room Overhead Cabinets • Bullet Lights over Bed Satin Brass Finish with His and Hers Switches • Wardrobe Closet Lights (N/A: 33PBD, 37PBD) 	<ul style="list-style-type: none"> • Energy Management System with 50 Amp Service • 50 Amp 120V Distribution Panel and Cord • 140 Watt Inverter • Storage Compartment Tank Monitor Gauge
PLUMBING AND LP SYSTEMS: FEATURES	OPTIONS	
<ul style="list-style-type: none"> • Kitchen Stainless Steel Sink with Single Lever Brushed Nickel Faucet • Separate Brushed Chrome Faucet for Filter Water • Bath Lavatory Faucet Single Handle Satin Nickel Finish • Demand Water System and Water Pump • 10 Gallon LP Gas/Electric Water Heater with Electronic Ignition, DSI • Winterization Valving System • Water Heater Bypass Valve • Toilet with Sprayer • No-Fuss Flush Holding Tank Rinsing System 	<ul style="list-style-type: none"> • Insulated Systems Compartment with Easy Access to Hook-Up • New Style Shower inside Wet Bay with Hot/Cold Water • Soap Dispenser inside Utility Bay • Gravity and Pressurized Water Fill • Contained Storage Area for Sewer Hose • One-Piece Fiberglass Shower • Shower Diverter, Shower Hose and Head • New Style Shower Light on Wall inside Shower Area • Brass Shower Door Frame with Obscure Glass 	<ul style="list-style-type: none"> • RV Sani-Con 2 System, Holding Tank Flush System with Hanging Bracket for Hose • Bathtub Option IPO Shower
HEATING, VENTS AND AIR CONDITIONING: FEATURES	OPTIONS	
<ul style="list-style-type: none"> • One 13.5M BTU and One 11.0M BTU Air Conditioner with Ducted Air and Wall Analog Thermostat Low-Profile Ford and Workhorse • 35M BTU Electronic Ignition Furnace • Electronic Dash AC/Heat Climate Control System • In-Floor Ducted Heating System with Metal Floor Registers 	<ul style="list-style-type: none"> • Kitchen Powered Attic Fan with Wall Control of Automatic Dome and Fan Power • Bath Powered Attic Fan with Wall Control of Automatic Dome and Fan Power • Metal Air Return Grill Furnace Antique Brass Finish • Metal Floor Registers Antique Brass 	<ul style="list-style-type: none"> • Dual 13.5M BTU Air Conditioner, Requires 50 Amp Service, Low-Profile Ford and Workhorse (New Option 33PBD, 34SBD) • Dual 13.5M BTU Air Conditioner with Heat Pumps, Requires 50 Amp Service, Low-Profile Ford and Workhorse • Fantastic 12V Attic Fan with Rain Sensor with Electronic Wall Thermostat Kitchen • Fantastic 12V Attic Fan with Rain Sensor with Electronic Wall Thermostat in Bath • 12V Heater in Wet Bay, Heat Pad on Fresh Tank

WINDOWS, DOORS AND AWNINGS: FEATURES		OPTIONS
<ul style="list-style-type: none"> Radius Flush-Mount Single Pane Safety Glass Dark Tinted Slider Windows Rear Wall Bedroom Window (33PBD, 37PBD, 37PCT) Bathroom Window (36DBD, 37PCT) Radius Entrance Door with Clear Glass, Roller Shade, Screen Door and Anti-Skid Steps 	<ul style="list-style-type: none"> Two Interior Grab Handles and One Exterior Grab Handle Topper Slide-Out Awnings Living Area and Bedroom Protecta Glaze Tinted Plexiglas® Skylight in Bathroom Awning Rail 	<ul style="list-style-type: none"> Radius Flush-Mount Dual Pane Safety Glass Dark Tinted Slider Windows Texture Vinyl Patio Awning Eclipse Texture Vinyl Automatic Patio Awning Texture Vinyl Window Awnings Living Area Slide-Out House Windows Bedroom Skylight (37PCT) Texture Vinyl Side Window Awning Bedroom (N/A: 33PBD, 37PBD, 37PCT)
SAFETY: FEATURES		
<ul style="list-style-type: none"> Fire Extinguisher Deadbolt Lock on Entrance Door 120V GFI Protected Circuit, Kitchen, Bath and Exterior 	<ul style="list-style-type: none"> LP Gas Detector Smoke Detector Carbon Monoxide Detector 	<ul style="list-style-type: none"> Pilot and Co-Pilot Three-Point Seat Belts Third Brake Safety Light Egress Window(s)

Due to the large variety of options and floorplan arrangements available to our customers, actual weights for each unit can differ significantly. Holiday Rambler provides a weight sticker on each unit we produce which includes that unit's tank capacities and approximate weight. Consult your local Holiday Rambler dealer for unit availability and further information.

The information printed in this brochure reflects product design, fabrication, and component parts at the date of printing. The manufacturer reserves the right, at any time, to make changes in product design or material or component specifications as its sole option, without notice. This includes the substitution of components of a different brand or trade name, which will result in comparable performance. All information printed in this brochure is subject to change after the date of printing. Some features shown or mentioned in this brochure are optional and may only be available in selected floorplans. Photographs may show props or decorations that are not standard equipment on Holiday Rambler models. Holiday Rambler, the HR logo and its design, are registered trademarks. All other products and company names are trademarks and/or registered trademarks of their respective holders.

While the color of the motorhome's exterior and the interior fabrics depicted in this sales brochure are fair and reasonable depictions, the colors depicted may not be an exact match of the actual colors because of the variances in photo-processing and variances caused by inserting the photographs within the sales brochure. Due to product improvements, changes during the model year and/or transcription errors that may occur, information represented within this brochure may not be accurate at the time of your purchase. If certain information is significant to your purchasing decision, please confirm the information with your dealer prior to submitting your order.

The actual overall length of the recreational vehicle may differ from that indicated in the brochure due to variances in the manufacturing process and/or installed components. The actual length may be greater or less than that indicated.

Component part and appliance manufacturers issue limited warranties covering those portions of the recreational vehicle not covered by the Limited Warranties issued by Monaco Coach Corporation. To learn which specific component parts and appliances are excluded from the Limited Warranties issued by Monaco Coach Corporation, please contact your selling dealership or Monaco Coach Corporation directly, or review the warranty packet inside the recreational vehicle.

Weights (Ford 20,500 Lb. Chassis)	33PBD	34SBD	36DBD	37PBD	37PCT
Gross Vehicle Weight Rating (Lbs.)	N/A	N/A	N/A	N/A	N/A
Gross Combined Weight Rating* (Lbs.)	N/A	N/A	N/A	N/A	N/A
Front Gross Axle Weight Rating (Lbs.)	N/A	N/A	N/A	N/A	N/A
Rear Gross Axle Weight Rating (Lbs.)	N/A	N/A	N/A	N/A	N/A
Weights (Workhorse 20,700 Lb. Chassis)					
Gross Vehicle Weight Rating (Lbs.)	20,700	N/A	N/A	N/A	N/A
Gross Combined Weight Rating* (Lbs.)	25,700	N/A	N/A	N/A	N/A
Front Gross Axle Weight Rating (Lbs.)	7,500	N/A	N/A	N/A	N/A
Rear Gross Axle Weight Rating (Lbs.)	13,500	N/A	N/A	N/A	N/A
Weights (Ford 22,000 Lb. Chassis) (33PBD Required Option for Ford Chassis)					
Gross Vehicle Weight Rating (Lbs.)	22,000	22,000	22,000	22,000	22,000
Gross Combined Weight Rating* (Lbs.)	26,000	26,000	26,000	26,000	26,000
Front Gross Axle Weight Rating (Lbs.)	7,500	7,500	7,500	7,500	7,500
Rear Gross Axle Weight Rating (Lbs.)	14,500	14,500	14,500	14,500	14,500
Weights (Workhorse 22,000 Lb. Chassis)					
Gross Vehicle Weight Rating (Lbs.)	N/A	22,000	22,000	22,000	22,000
Gross Combined Weight Rating* (Lbs.)	N/A	26,000	26,000	26,000	26,000
Front Gross Axle Weight Rating (Lbs.)	N/A	8,000	8,000	8,000	8,000
Rear Gross Axle Weight Rating (Lbs.)	N/A	14,500	14,500	14,500	14,500
Measurements					
Wheelbase	228"	228"	242"	242"	242"
Overall Length	34' 3"	35' 2"	36' 9"	37' 4"	37' 4"
Overall Height, Including A/C	N/A	12' 6"	12' 6"	12' 6"	12' 6"
Interior Height	84"	84"	84"	84"	84"
Interior Width	94.5"	94.5"	94.5"	94.5"	94.5"
Exterior Width	100.5"	100.5"	100.5"	100.5"	100.5"
Tank Capacities**					
Water Heater (Gal.)	10	10	10	10	10
Gray Tank (Gal.)	45	40	42/39	45	45
Black Tank (Gal.)	54	42	42/39	45	54
Fresh Tank (Gal.)	60	60	60	60	60
LP Tank (Gal.)***	24	24	24	24	24

* Towing capacity is limited by GCWR; your vehicle's towing capacity is the difference between the GCWR and the actual vehicle weight, including all water, fuel, passengers and cargo. Your towed vehicle should be equipped with auxiliary brakes if the weight of the towed vehicle exceeds 1,000 lbs. Consult your Owner's Manual for further towing information.

** Variances in the fabrication and installation of the tanks may cause the actual "usable capacity" to be greater or less than the capacities designated above.

*** Actual filled LP capacity is 80% of listing due to safety shut-off required on tank.

33PBD

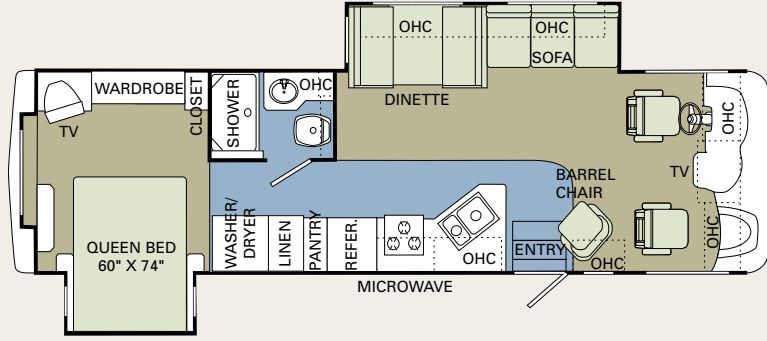

34SBD

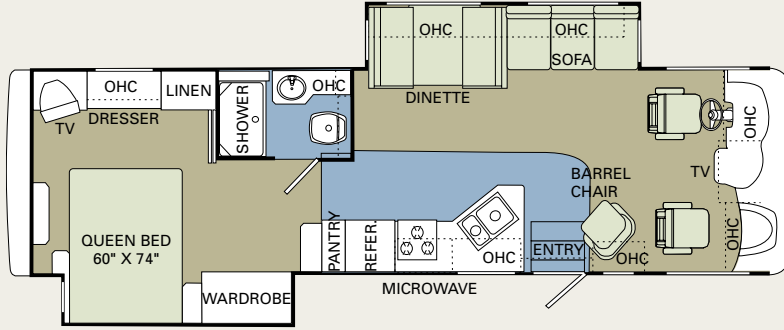

36DBD

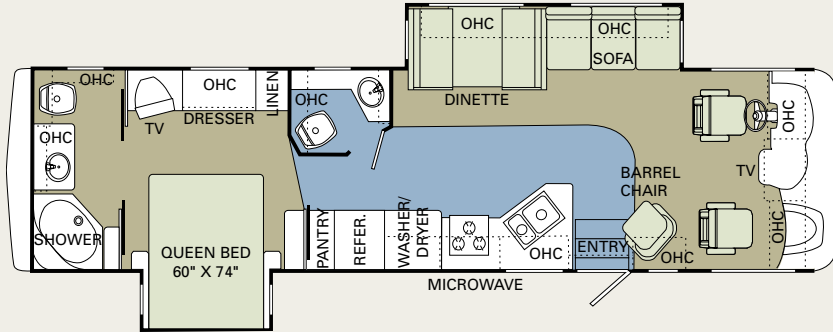

37PBD

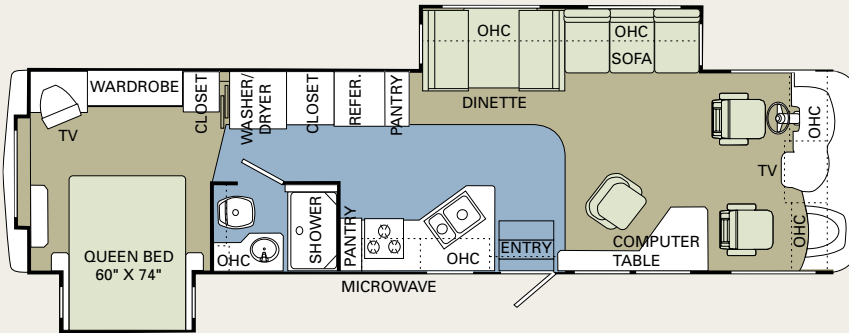

37PCT

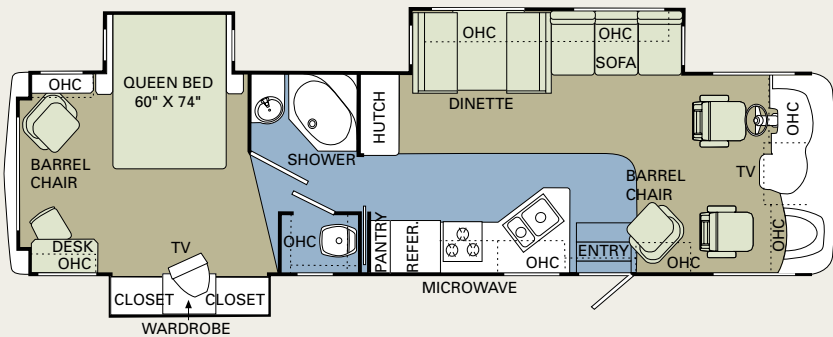

■ Carpet ■ Tile

You can find the 30PDD floorplan on page 19.

ADMIRAL SE 30PDD

THE SHORTER COACH THAT'S BIG ON VALUE.

Our popular 30PDD floorplan gives you all the comfort and luxury you'd expect from Holiday Rambler — in a shorter, value-packed floorplan. The 30PDD offers a long list of excellent features, including the exclusive Panaview™ 1-piece windshield, new side-hinged baggage doors and a new peaked one-piece insulated fiberglass roof.



BODY CONSTRUCTION: FEATURES

- Alumaframe® Superstructure
- Steel Cage Cockpit Construction
- Peaked One-Piece Fiberglass Roof with Fiberglass Insulation
- Smooth Aluminum Exterior Walls
- Front and Rear Molded Fiberglass Caps
- One-Piece Front Windshield
- Interior Height, 84"
- Aluminum Framed Floor on Steel Trusses
- Laminated Structurwood™ Flooring
- Interior Paneling with 3/4" Insulation
- Foam Insulated Floor Framing with 3-Ply Underbelly
- One-Piece Engine Cover
- Black Front-Mounted Exterior Mirrors
- Low-Profile Sealed LED Marker Lights
- New Style Taillights
- Integrated Metal Fuel Door with Lock
- Sofa and Dinette Slide-Out House to 147" Wide
- 30" Deep Bedroom Slide-Out Houses
- Pass-Through Storage Bays under Slide-Outs with Roto Cast Boxes
- Side-Hinged Baggage Doors; All Door Locations with Redesigned Extrusion and Latch Locations
- One-Piece Polyethylene Storage Compartment
- Painted Skirt with Vinyl Exterior Graphics
- Rear Ladder
- Interior Rubber Entry Steps
- Exterior Double Entry Steps
- Undercoating

WORKHORSE 18,000 LB. CHASSIS/ENGINE/SUSPENSION: FEATURES

- 8.1L V-8 Gasoline Engine with Electronic Fuel Injection
- Engine Displacement: 8.1L/496 Cu. In.
- Power: 340 HP
- Torque: 455 lbs./ft.
- 4-Speed Automatic Transmission with Overdrive
- Fuel Tank Capacity 75 Gallon
- 145 Amp Alternator
- Rear Axle Ratio: 4.63:1
- Radial Tires: 225/70R x 19.5F
- Stainless Steel Wheel Liners
- Leaf Spring Suspension
- ABS Brake System
- Fully Automatic Hydraulic Leveling System
- Pre-Wire for Supplemental Braking System
- Hitch Receiver with Dual Connector 4-Pin or 7-Pin, 4,000 Lb. Hitch
- Smartstructure II

OPTIONS

- Fully Automatic Hydraulic Leveling System
- Stainless Steel Wheel Simulators, Standard on Workhorse Chassis

FORD 20,500 LB. CHASSIS/ENGINE/SUSPENSION: FEATURES

- 6.8L 3-Valve V-10 Gasoline Engine with Electronic Fuel Injection
- Engine Displacement: 6.8L/415 Cu. In.
- Power: 362 HP
- Torque: 457 lbs./ft.
- TorqShift 5-Speed Automatic Overdrive Transmission with Tow/Haul Mode
- New Transmission Oil Temperature Gauge
- Fuel Tank Capacity 75 Gallon
- 130 Amp Alternator
- Rear Axle Ratio: 5.38:1
- Radial Tires: 245/70R x 19.5F
- Wheel/Rims with Chrome Wheel Covers
- Leaf Spring Suspension
- Front and Rear Disc, 4-Wheel Anti-Lock Brakes
- Heavy-Duty Front Track Bar with Bilstein® Shock Absorbers
- Pre-Wire for Supplemental Braking System
- Hitch Receiver with Dual Connector 4-Pin or 7-Pin, 5,000 Lb. Hitch
- SmartStructure II

OPTIONS

- Fully Automatic Hydraulic Leveling System
- Stainless Steel Wheel Simulators, Standard on Workhorse Chassis

WORKHORSE 20,700 LB. CHASSIS/ENGINE/SUSPENSION: FEATURES

- 8.1L V-8 Gasoline Engine with Electronic Fuel Injection
- Engine Displacement: 8.1L/496 Cu. In.
- Power: 340 HP
- Torque: 455 lbs./ft.
- 6-Speed Automatic Transmission with Overdrive
- Fuel Tank Capacity 75 Gallon
- 145 Amp Alternator
- Rear Axle Ratio: 5.13:1
- Radial Tires: 245/70R x 19.5F
- Stainless Steel Wheel Liners
- Leaf Spring Suspension
- ABS Brake System
- Pre-Wire for Supplemental Braking System
- Hitch Receiver with Dual Connector 4-Pin or 7-Pin, 5,000 Lb. Hitch
- SmartStructure II

OPTIONS

- Fully Automatic Hydraulic Leveling System
- Stainless Steel Wheel Simulators, Standard on Workhorse Chassis

STANDARDS/OPTIONS

COCKPIT: FEATURES		OPTIONS
<ul style="list-style-type: none"> Fiberglass Automotive Dash with Burlwood Instrumentation Panel and Two-Tone Dash Vinyl CD Player/Radio with Six Speakers Multi-Positioned Sunvisors Rear Vision System Prep Intermittent Windshield Wipers Tilt Steering Wheel Cruise Control Power Steering Electric Automotive Horn 	<ul style="list-style-type: none"> Wood Center Console on Engine Cover, Recess Tray with Rubber Mat and Plastic Two-Tier Cup Holders: Front Tip-Door Ford/Front Drawer Workhorse Chassis New Style Fabric Pilot and Co-Pilot Recliner Seats Carpeted Driver and Passenger Floor Mats Dash Workstation Wood Framed Cabinet Doors with Smoked Glass over Front Entertainment Center Systems Secure Front Cab over TVs with Steel Framing 	<ul style="list-style-type: none"> Six-Way Power Pilot Seat Rear Vision System with Audio and Adjustable Camera
APPLIANCES AND ACCESSORIES: FEATURES		OPTIONS
<ul style="list-style-type: none"> Double-Door Refrigerator High-Output 3-Burner Cooktop without Oven Bi-Fold Range Cover Microwave with Touch Control and Under-Mounted Range Hood 24" Flatscreen Stereo Color TV with Remote Control in Cockpit Overhead 	<ul style="list-style-type: none"> TV Antenna DVD Prep and Video Control Box with Booster Exterior Hook-Ups for DSS Dish and Cable Interior Cable TV Hook-Up and Telephone Jacks Digital Satellite System Prep Exterior Gas Line Hook-Up Prep for LP Accessories 	<ul style="list-style-type: none"> Large Double-Door Refrigerator 8 Cu. Ft. High-Output Three-Burner Range with Oven Convection Microwave with Touch Control and Under Mounted Range Hood 20" Color TV with Remote Control in Bedroom
INTERIOR: FEATURES		OPTIONS
<ul style="list-style-type: none"> New Vintage Oak Cabinetry Flat Panel Cabinet Doors on Overhead Cabinets, Base Cabinets and Wardrobes Cabinet End Panels Wood Grain Refrigerator Panel Insert Wallpaper Border Kitchen and Rear Bedroom Wall Self-Supporting Top-Hinged Overhead Storage Doors and Positive Catches on All Other Doors Heavy-Duty Ball Bearing Drawer Guides Wood Cabinet Drawer Boxes Wood Interior Grab Handle on Cabinet at Entry Door Satin Brass Cabinetry Hardware and Bath Accessories Laminate Kitchen Countertop with Decorative Backsplash, Stainless Steel Sink, Brushed Nickel Faucet and Two Sink Covers Toe Kicks Kitchen and Bath Base Cabinets Laminate Bathroom Countertop with Decorative Backsplash and Laminate Perm-Edge 	<ul style="list-style-type: none"> All Other Countertops are Laminate with Wood Edge Kitchen Overhead Cabinets with Adjustable Shelf Silverware Drawer with Organizer Kitchen Base Cabinets (N/A with Range Option) Linoleum Flooring in Kitchen and Bath, Kitchen Flooring to Include Entry Door Upgrade Nylon Carpeting with Pad in Living Area and Bedroom Soft Touch Padded Vinyl Ceiling Wood Slide-Out Fascia with Vinyl Inserts Bathroom Lavatory Base Mirror with Wood Frame Bedroom Swing-Away TV Cabinets with TV Option Bedspread with Two Decorative Pillows New Style Fabric Headboard Pleated Day/Night Blackout Shades Living Area and Bedroom Soil Repellant on Fabric 	<ul style="list-style-type: none"> Decors: Moroccan Sunset, Saville Row II, Bronzeville, Jadestone, Ebony Vine II Wood Choice: Newport Cherry, Champagne Select
FURNITURE: FEATURES		OPTIONS
<ul style="list-style-type: none"> Queen Bed with Nightstands Bedroom Desk Arched Back Wood Booth Dinette with Side-Sliding Table Top 	<ul style="list-style-type: none"> Forward-Facing Seat Belts in Booth Dinette inside Living Area Slide-Out New Style Fabric Jackknife Sofa, Two Pillows on All Sofas 	<ul style="list-style-type: none"> New Style Fabric Hide-A-Bed Sofa with Two Pillows
ELECTRICAL SYSTEMS AND LIGHTS: FEATURES		
<ul style="list-style-type: none"> 30 Amp 120V Distribution Panel and Power Cord 60 Amp Electronic 12V Power Converter Onan® 4.0 kW Gas Generator Two 6V House Batteries Battery Disconnect Switches 12V and 110V Outlet in Cockpit Area Porch Light and Exterior Step Light on Same Switch 	<ul style="list-style-type: none"> Exterior Power Entry Step with Light Water Pump Switch in Service Bay Area and Convenience Center Lights in Outside Storage Compartments 120V Receptacles in Outside Storage Compartment Underhood Utility Light Receptacle and Phone Jack in Dinette Area 	<ul style="list-style-type: none"> Directional Map Lights Pilot and Co-Pilot Seats Decorative Satin Brass Dinette Overhead Satin Brass Decorative Bathroom Wall Light Halogen Lights under Living Room and Dining Room Overhead Cabinets Bullet Lights over Bed Satin Brass Finish with His and Hers Switches

PLUMBING: FEATURES

- Kitchen Stainless Steel Sink with Single Lever Brushed Nickel Faucet
- Bath Lavatory Faucet Single Handle Brass Finish
- Demand Water System and Water Pump
- 6 Gallon LP Gas/Electric Water Heater with Electronic Ignition, DSI
- Winterization Valving System
- Water Heater Bypass Valve
- Toilet with Sprayer
- No-Fuss Flush Holding Tank Rinsing System
- Insulated Systems Compartment with Easy Access to Hook-Up
- New Style Shower inside Wet Bay with Hot/Cold Water
- Gravity and Pressurized Water Fill
- Contained Storage Area for Sewer Hose
- One-Piece Fiberglass Shower
- Shower Diverter, Shower Hose and Head
- Brass Shower Door Frame with Obscure Glass

HEATING, VENTS AND AIR CONDITIONING: FEATURES

- One 13.5M BTU Air Conditioner with Ducted Air and Analog Wall Thermostat, Low-Profile Ford and Workhorse
- 35M BTU Electronic Ignition Furnace
- Electronic Dash AC/Heat Climate Control System
- In-Floor Ducted Heating System with Metal Floor Registers
- Living Area Powered Attic Fan with Wall Control of Automatic Dome and Fan Power
- Bath Powered Attic Fan with Wall Control of Automatic Dome and Fan Power
- Metal Air Return Grill Furnace Antique Brass Finish
- Metal Floor Registers Antique Brass

OPTIONS

- One 15M BTU Air Conditioner with Ducted Air and Analog Wall Thermostat, Low-Profile Ford and Workhorse

WINDOWS, DOORS AND AWNINGS: FEATURES

- Radius Flush-Mount Single Pane Safety Glass Dark Tinted Slider Windows
- Radius Entrance Door with Clear Glass, Roller Shade, Screen Door and Anti-Skid Steps
- One Interior Grab Handle and One Exterior Grab Handle
- Topper Slide-Out Awnings Living Area and Bedroom
- Protecta Glaze Tinted Plexiglas® Skylight in Bathroom
- Awning Rail

OPTIONS

- Texture Vinyl Patio Awning

SAFETY: FEATURES

- Fire Extinguisher
- Deadbolt Lock on Entrance Door
- 120V GFI Protected Circuit, Kitchen, Bath and Exterior
- LP Gas Detector
- Smoke Detector
- Carbon Monoxide Detector
- Pilot and Co-Pilot Three-Point Seat Belts
- Third Brake Safety Light
- Egress Window

STANDARDS/OPTIONS

Weights (Workhorse 18,000 Lb. Chassis)

Gross Vehicle Weight Rating (Lbs.)	18,000
Gross Combined Weight Rating* (Lbs.)	22,000
Front Gross Axle Weight Rating (Lbs.)	7,000
Rear Gross Axle Weight Rating (Lbs.)	12,000

Weights (Ford 20,500 Lb. Chassis)

Gross Vehicle Weight Rating (Lbs.)	20,500
Gross Combined Weight Rating* (Lbs.)	25,500
Front Gross Axle Weight Rating (Lbs.)	7,000
Rear Gross Axle Weight Rating (Lbs.)	13,500

Weights (Workhorse 20,700 Lb. Chassis)

Gross Vehicle Weight Rating (Lbs.)	20,700
Gross Combined Weight Rating* (Lbs.)	25,700
Front Gross Axle Weight Rating (Lbs.)	7,500
Rear Gross Axle Weight Rating (Lbs.)	13,500

Measurements

Wheelbase	190"
Overall Length	31' 0"
Overall Height, Including A/C 20,500/20,700 Lb.	12' 6"
Overall Height, Including A/C 18,000 Lb.	12' 4"
Interior Height	84"
Interior Width	94.5"
Exterior Width	100.5"

Tank Capacities**

Water Heater (Gal.)	6
Gray Tank (Gal.)	42
Black Tank (Gal.)	42
Fresh Tank (Gal.)	60
LP Tank (Gal.)***	24

ADMIRAL SE 30PDD

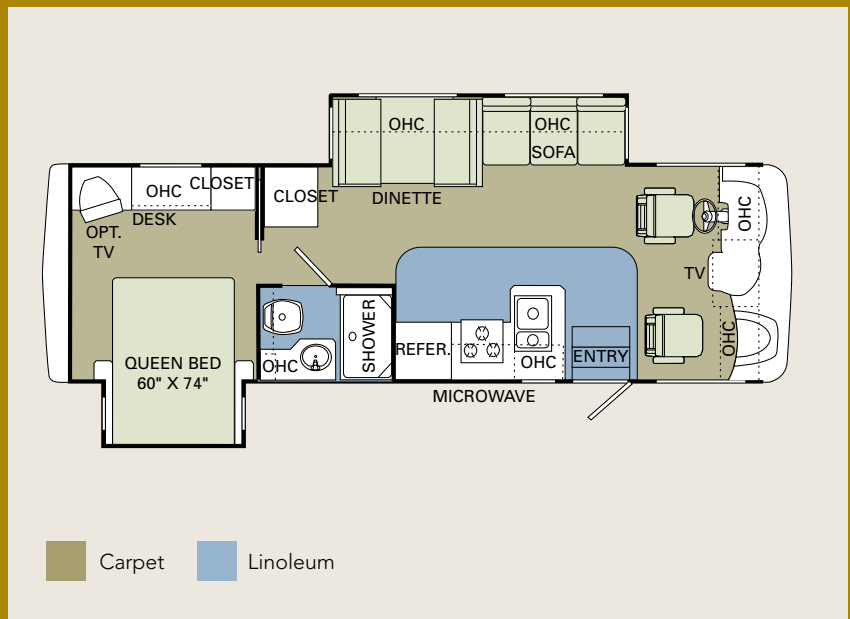

WEIGHTS/MEASUREMENTS

* Towing capacity is limited by GCWR; your vehicle's towing capacity is the difference between the GCWR and the actual vehicle weight, including all water, fuel, passengers and cargo. Your towed vehicle should be equipped with auxiliary brakes if the weight of the towed vehicle exceeds 1,000 lbs. Consult your Owner's Manual for further towing information.

** Variances in the fabrication and installation of the tanks may cause the actual "usable capacity" to be greater or less than the capacities designated above.

*** Actual filled LP capacity is 80% of listing due to safety shut-off required on tank.

20 ADMIRAL SE® 06



Thank you for taking a closer look at the 2006 Admiral SE. In addition to its many creature comforts, this value-packed gas coach includes countless conveniences and safety innovations you'll want to experience firsthand. Poke around. Kick the tires. Open and shut every door and drawer — twice. And most importantly, take a drive. You can count on our expert sales team to answer all your questions and demonstrate why this truly is the best experience the road has to offer.

WARRANTIES

12 MONTH/24,000 MILE basic limited warranty

5 YEAR/50,000 MILE limited warranty on aluminum or steel frame structure of sidewall, roof, front and rear cap

3 YEAR/36,000 MILE limited warranty on Ford or Workhorse chassis

Applies to certain models. See owner's manual for complete details.

ALL EYES ON THE ROAD AHEAD.

If you're considering a Holiday Rambler, chances are you share our pioneer spirit. For us, it goes back to 1953, the year we introduced our first travel trailer. Since then, our countless innovations have helped create a rich, rewarding lifestyle — and a new way for families like yours to go exploring.

Yes, we're proud of our heritage — but we're not looking back. In these pages, you'll discover that we continue to lead the entire industry. With exciting new features, powerful chassis, remarkable floorplans and, as always, more ways of keeping you and your loved ones safe.

Whether you're looking for the value of a towable, the convenience and economy of a gas motorhome or the top-of-the-line luxury of a diesel coach — Holiday Rambler has an unbeatable model for your budget. Because in 2006, one thing's for sure. We're still paving the way.



HOLIDAY RAMBLER®

This is Living®

606 Nelson's Parkway Wakarusa, IN 46573

www.holidayrambler.com
(800) 245-4778

MONACO COACH CORPORATION

Monaco is traded on the New York Stock Exchange under the listing MNC.
© 2005, Monaco Coach Corporation 11/05 NPN: BROHADM Litho in USA.

